

## 5,08 mm SOCKET PRINTED CIRCUIT TERMINAL – MALE 180° OPEN



Production Code : 213 SBDK-E2A



### TECHNICAL DATA

#### DIMENSIONS

Width	65,92 mm
Height	12,00 mm
Depth	8,00 mm
Pin range	5,08 mm
Pin thickness	1x1 mm
Pin hole diameter	1,55 mm

### TECHNICAL DATA

Current	16 A
Voltage	250 V
Cable cross section	-
Screw size	-
Nominal torque	-
Flammability rating	V0
Coating of metals	μ3+AG

### GENERAL ORDERING DATA

Type	5,08 mm Socket Term. Ser.Male 180°Open Pin13
Qty	50 pcs
Order no	10.363 - 11.363 - 12.363 13.363 - 14.363 - 15.363
Package weight	0,28 kg
Packaging	Box
Min. Order Qty	50 pcs
Country of origin	TURKEY

\* Stock colors are blue and green.

### CERTIFICATES

CERTIFICATE	ISSUED BY
TS 10487 EN 60998-2-1	TSE
CE	SZUTEST CO.
RoHS	İNTERTEK A.Ş.
EAC	SERCONS

## DRAWINGS

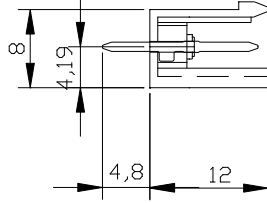
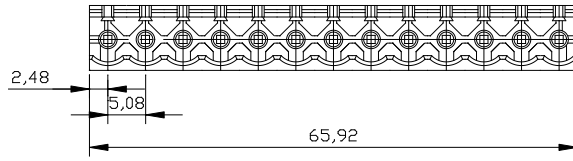

## Diagram

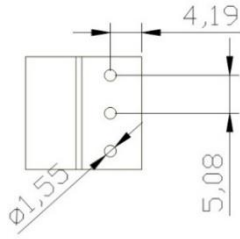

## COMBINE PRODUCTS

5,08 mm SBDK-D (10.213)

