

## 5,08 mm SOCKET PRINTED CIRCUIT TERMINAL – MALE 90° OPEN



Production Code : 223 SBDK-E1A



### TECHNICAL DATA

#### DIMENSIONS

Width	116,72 mm
Height	12,00 mm
Depth	8,00 mm
Pin range	5,08 mm
Pin thickness	1x1 mm
Pin hole diameter	1,55 mm

### TECHNICAL DATA

Current	16 A
Voltage	250 V
Cable cross section	-
Screw size	-
Nominal torque	-
Flammability rating	V0
Coating of metals	μ3+AG

### GENERAL ORDERING DATA

Type	5,08 mm Socket Term. Ser. Male 90° Open Pin 23
Qty	25 pcs
Order no	10.323 - 11.323 - 12.323 13.323 - 14.323 - 15.323
Package weight	0,25 kg
Packaging	Box
Min. Order Qty	25 pcs
Country of origin	TURKEY

\* Stock colors are blue and green.

### CERTIFICATES

CERTIFICATE	ISSUED BY
TS 10487 EN 60998-2-1	TSE
CE	SZUTEST CO.
RoHS	İNTERTEK A.Ş.
EAC	SERCONS

Parseller Mah. Kuyu Sok. No:30 Ümraniye/İstanbul

Tel : +90 216 632 90 04 Fax : +90 216 632 89 31

[www.megaradar.com.tr](http://www.megaradar.com.tr) [megaradar@megaradar.com.tr](mailto:megaradar@megaradar.com.tr)

## DRAWINGS

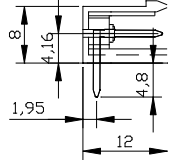
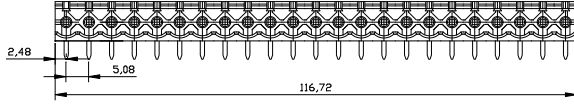

## Diagram

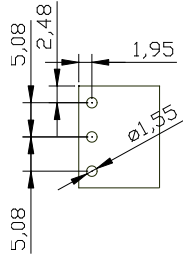

## COMBINE PRODUCTS

### 5,08 mm SBDK-D (10.223)

