

5,08 mm SOCKET PRINTED CIRCUIT TERMINAL – MALE 90° OPEN



Production Code : 203 SBDK-E1A



TECHNICAL DATA

DIMENSIONS

Width	15,12 mm
Height	12,00 mm
Depth	8,00 mm
Pin range	5,08 mm
Pin thickness	1x1 mm
Pin hole diameter	1,55 mm

TECHNICAL DATA

Current	16 A
Voltage	250 V
Cable cross section	-
Screw size	-
Nominal torque	-
Flammability rating	V0
Coating of metals	μ3+AG

GENERAL ORDERING DATA

Type	5,08 mm Socket Term. Ser. Male 90° Open Pin 3
Qty	100 pcs
Order no	10.303 - 11.303 - 12.303 13.303 - 14.303 - 15.303
Package weight	0,13 kg
Packaging	Box
Min. Order Qty	100 pcs
Country of origin	TURKEY

* Stock colors are blue and green.

CERTIFICATES

CERTIFICATE	ISSUED BY
TS 10487 EN 60998-2-1	TSE
CE	SZUTEST CO.
RoHS	İNTERTEK A.Ş.
EAC	SERCONS

Parseller Mah. Kuyu Sok. No:30 Ümraniye/İstanbul

Tel : +90 216 632 90 04 Fax : +90 216 632 89 31

www.megaradar.com.tr megaradar@megaradar.com.tr

**MEGARADAR®**

Elektrik Elektronik İnşaat San. Tic. A.Ş.

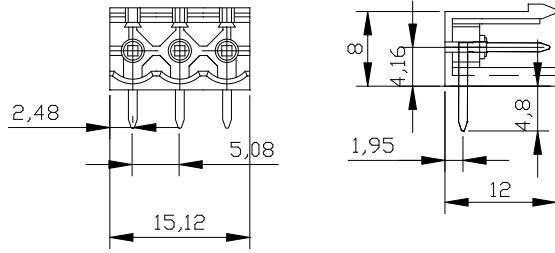
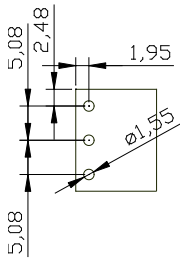
DRAWINGS**Diagram****COMBINE PRODUCTS****5,08 mm SBDK-D (10.203)**